

# Lensagon B5M4020

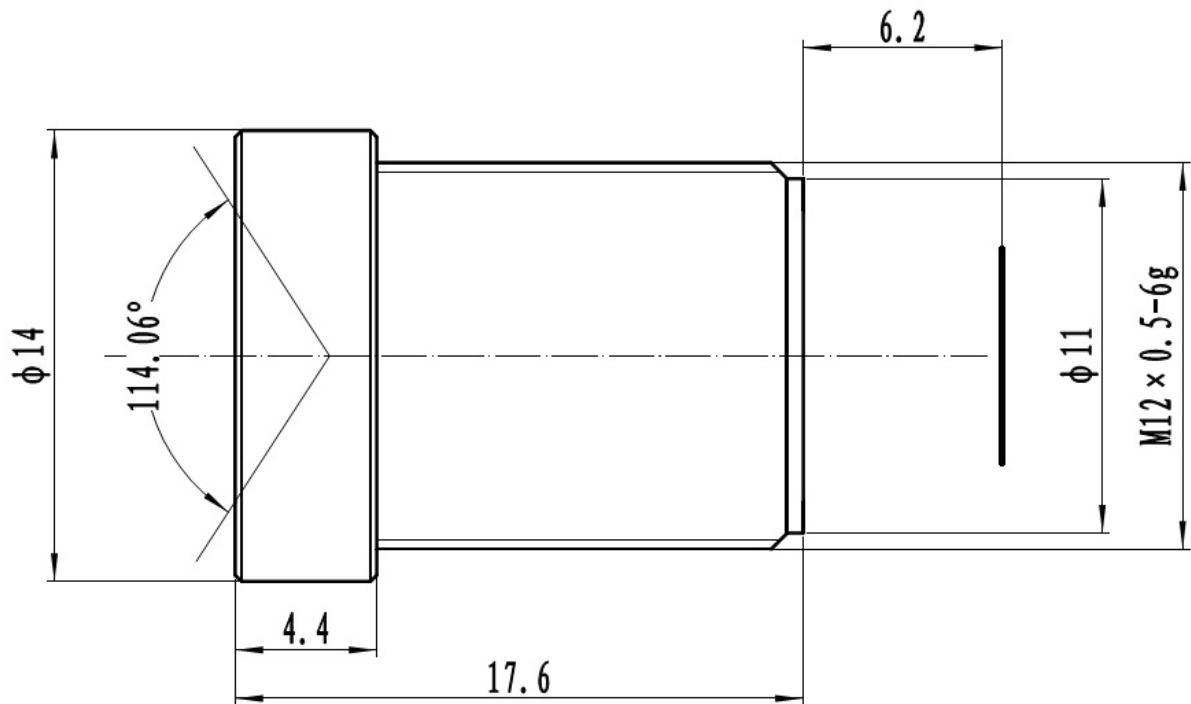

The S-Mount lens Lensagon B5M4020 is suitable for common sensors up to 5 megapixel with an image format of 1/2.5 inch. It is characterized by a particularly high light intensity.

## Technical Data

Mount	S-Mount
Sensor	1/2.5 inch
Focal Length	4 mm
Aperture	2
MOD	0.3 m
Back Focal	6.7 mm
Angle of View	D:114° H:91.2° V:68.4°
Megapixel	5 MP
IR Cut Filter	No
Weight	5.6 g
Iris	fixed
Focus	fixed
Typ	Standard



Light Sensitive



5 Megapixel

